

TEMP (°F)	FACTOR
70	1.00
150	0.97
200	0.94
300	0.88
400	0.83
500	0.78
600	0.77
1000	0.60
1400	0.42

NOTE: 5/8"-11 HANGER NUTS INSTALLED ON ALL LOOPS 2 1/2" AND UP.  
ALL LOOPS INCLUDE 3/8" NPT DRAIN/AIR RELEASE PLUG

CONTACT FACTORY FOR ADDITIONAL SIZES AND MOVEMENTS. ALL UNITS IN INCHES UNLESS NOTED.

QTY.	PART NO.	SIZE	A	B	MVMT	SPRING RATE (LBS/IN)	PSI @ 70°F*		WT (LBS)
							SINGLE	DOUBLE	
	LOOPF80200	2	15	24 1/2	±4	20	516	826	24
	LOOPF80250	2 1/2	16 3/4	28 1/4	±4	21	387	619	36
	LOOPF80300	3	19 3/8	30	±4	23	316	506	50
	LOOPF80400	4	25 5/8	35 3/8	±4	30	232	371	69
	LOOPF80500	5	31 7/8	40 1/4	±4	47	191	306	101
	LOOPF80600	6	38 1/8	45 3/8	±4	51	165	264	163
	LOOPF80800	8	50 1/2	53 1/2	±4	65	234	374	309
	LOOPF81000	10	62 7/8	63 1/4	±4	71	230	367	484
	LOOPF81200	12	75 3/8	72 3/4	±4	98	160	257	666

\*HOSE AND BRAID MAXIMUM WORKING PRESSURE RATING. FOR PRESSURE RATINGS AT OTHER TEMPERATURES, CONSULT THE CORRECTION FACTOR TABLE ABOVE. LOOPS FOR STEAM APPLICATIONS WILL BE DOUBLE BRAIDED BUT USE THE SINGLE BRAIDED PRESSURE RATING. LOOPS FOR STEAM APPLICATIONS SHOULD BE INSTALLED HORIZONTALLY TO PREVENT CONDENSATE BUILD UP. CONTACT FACTORY FOR FURTHER INFORMATION.



2315 W. HUBBARD ST.  
CHICAGO, IL 60612  
TEL: 312-738-3588  
FAX: 800-533-1024  
WWW.FLEXICRAFT.COM

PROPOSAL/INQUIRY/ORDER NO:

CUSTOMER NAME:

## ML EXPANSION LOOP

150# RFSO FLANGES, ±4" MOVEMENT

PROJECT NAME:

DRAWN BY: JULIANH

DATE: 04/14/2026

APPROVED BY:

DATE:

CONTRACTOR:

DRAWING NO:

LOOPF8

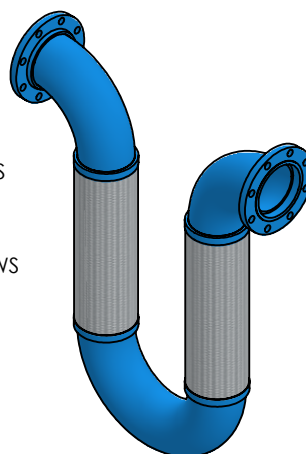
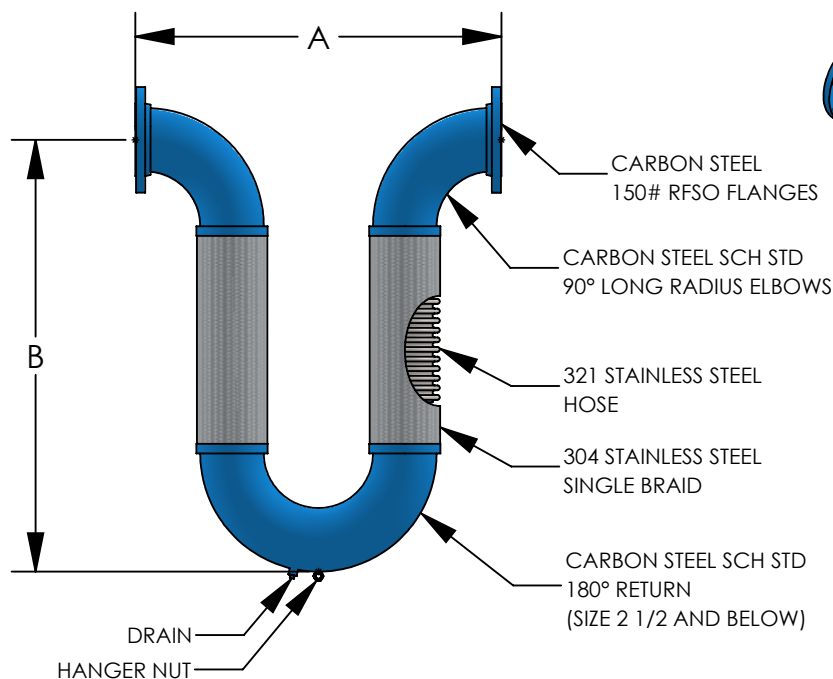

TEMP (°F)	FACTOR
70	1.00
150	0.97
200	0.94
300	0.88
400	0.83
500	0.78
600	0.77
1000	0.60
1400	0.42

NOTE: 5/8"-11 HANGER NUTS INSTALLED ON ALL LOOPS 2 1/2" AND UP. ALL LOOPS INCLUDE 3/8" NPT DRAIN/AIR RELEASE PLUG

CONTACT FACTORY FOR ADDITIONAL SIZES AND MOVEMENTS. ALL UNITS IN INCHES UNLESS NOTED.

QTY.	PART NO.	SIZE	A	B	MVMT	SPRING RATE (LBS/IN)	PSI @ 70°F*		WT (LBS)
							SINGLE	DOUBLE	
	LOOPF30200	2	13	17 3/8	±1 1/2	52	516	826	21
	LOOPF30250	2 1/2	16 1/4	21	±1 1/2	56	387	619	30
	LOOPF30300	3	19 3/8	23 3/8	±1 1/2	60	316	506	46
	LOOPF30400	4	25 5/8	28	±1 1/2	80	232	371	63
	LOOPF30500	5	31 7/8	32 1/4	±1 1/2	124	191	306	91
	LOOPF30600	6	38 1/8	36 3/4	±1 1/2	135	165	264	148
	LOOPF30800	8	50 1/2	44 1/2	±1 1/2	174	234	374	287
	LOOPF31000	10	62 7/8	53 1/4	±1 1/2	189	230	367	453
	LOOPF31200	12	75 3/8	61 3/4	±1 1/2	260	160	257	636

\*HOSE AND BRAID MAXIMUM WORKING PRESSURE RATING. FOR PRESSURE RATINGS AT OTHER TEMPERATURES, CONSULT THE CORRECTION FACTOR TABLE ABOVE. LOOPS FOR STEAM APPLICATIONS WILL BE DOUBLE BRAIDED BUT USE THE SINGLE BRAIDED PRESSURE RATING. LOOPS FOR STEAM APPLICATIONS SHOULD BE INSTALLED HORIZONTALLY TO PREVENT CONDENSATE BUILD UP. CONTACT FACTORY FOR FURTHER INFORMATION.



2315 W. HUBBARD ST.  
CHICAGO, IL 60612  
TEL: 312-738-3588  
FAX: 800-533-1024  
WWW.FLEXICRAFT.COM

PROPOSAL/INQUIRY/ORDER NO:

CUSTOMER NAME:

PROJECT NAME:

CONTRACTOR:

## ML EXPANSION LOOP

150# RFSO FLANGES, ±1 1/2" MOVEMENT

DRAWN BY: JULIANH

DATE: 04/14/2026

APPROVED BY:

DATE:

DRAWING NO:

LOOPF3

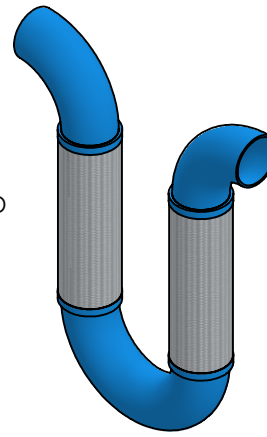
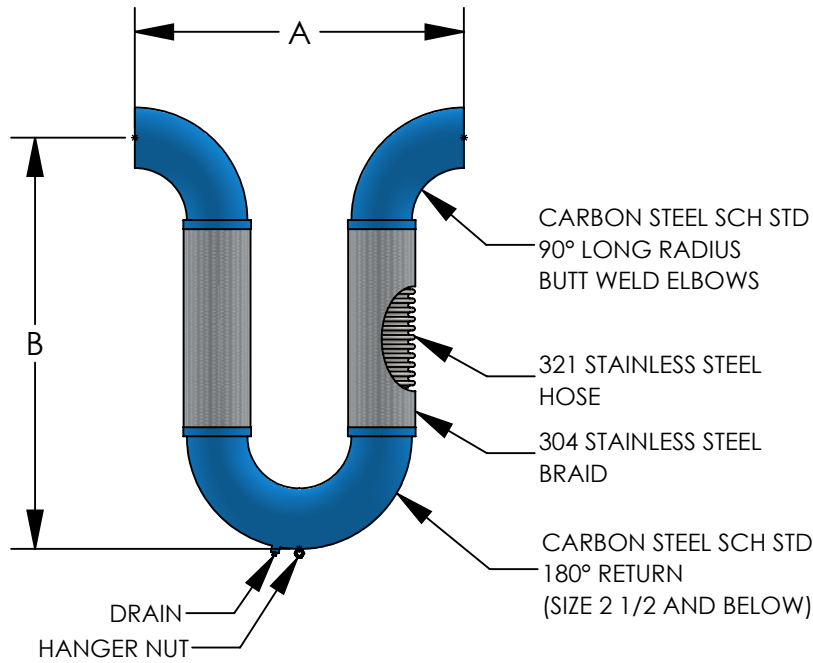

TEMP (°F)	FACTOR
70	1.00
150	0.97
200	0.94
300	0.88
400	0.83
500	0.78
600	0.77
1000	0.60
1400	0.42

NOTE: 5/8"-11 HANGER NUTS INSTALLED ON ALL LOOPS 2 1/2" AND UP.  
ALL LOOPS INCLUDE 3/8" NPT DRAIN/AIR RELEASE PLUG

CONTACT FACTORY FOR ADDITIONAL SIZES AND MOVEMENTS. ALL UNITS IN INCHES UNLESS NOTED.

QTY.	PART NO.	SIZE	A	B	MVMT	SPRING RATE (LBS/IN)	PSI @ 70°F*		WT (LBS)
							SINGLE	DOUBLE	
	LOOPW30500	1/2	6	10 1/4	±1 1/2	30	1075	1720	2.5
	LOOPW30075	3/4	6	11 1/2	±1 1/2	32	792	1267	2.5
	LOOPW30100	1	6	12	±1 1/2	36	571	914	4
	LOOPW30125	1 1/4	7 1/2	13 3/8	±1 1/2	44	531	850	6
	LOOPW30150	1 1/2	9	14 3/4	±1 1/2	47	472	755	9
	LOOPW30200	2	12	17 3/8	±1 1/2	52	516	826	13
	LOOPW30250	2 1/2	15	21	±1 1/2	56	387	619	20
	LOOPW30300	3	18	23 3/8	±1 1/2	60	316	506	35
	LOOPW30400	4	24	28	±1 1/2	80	232	371	48
	LOOPW30500	5	30	32 1/4	±1 1/2	124	191	306	81
	LOOPW30600	6	36	36 3/4	±1 1/2	135	165	264	125
	LOOPW30800	8	48	44 1/2	±1 1/2	174	234	374	245
	LOOPW31000	10	60	53 1/4	±1 1/2	189	230	367	403
	LOOPW31200	12	72	61 3/4	±1 1/2	260	160	257	556

\*HOSE AND BRAID MAXIMUM WORKING PRESSURE RATING. FOR PRESSURE RATINGS AT OTHER TEMPERATURES, CONSULT THE CORRECTION FACTOR TABLE ABOVE. LOOPS FOR STEAM APPLICATIONS WILL BE DOUBLE BRAIDED BUT USE THE SINGLE BRAIDED PRESSURE RATING. LOOPS FOR STEAM APPLICATIONS SHOULD BE INSTALLED HORIZONTALLY TO PREVENT CONDENSATE BUILD UP. CONTACT FACTORY FOR FURTHER INFORMATION.



2315 W. HUBBARD ST.  
CHICAGO, IL 60612  
TEL: 312-738-3588  
FAX: 800-533-1024  
WWW.FLEXICRAFT.COM

PROPOSAL/INQUIRY/ORDER NO:

CUSTOMER NAME:

PROJECT NAME:

CONTRACTOR:

## ML EXPANSION LOOP

### WELD ENDS, ±1 1/2" MOVEMENT

DRAWN BY: JULIANH

DATE: 04/13/2026

APPROVED BY:

DATE:

DRAWING NO:

LOOPW3

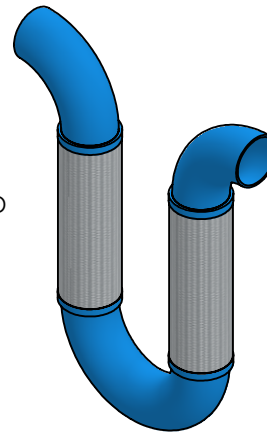
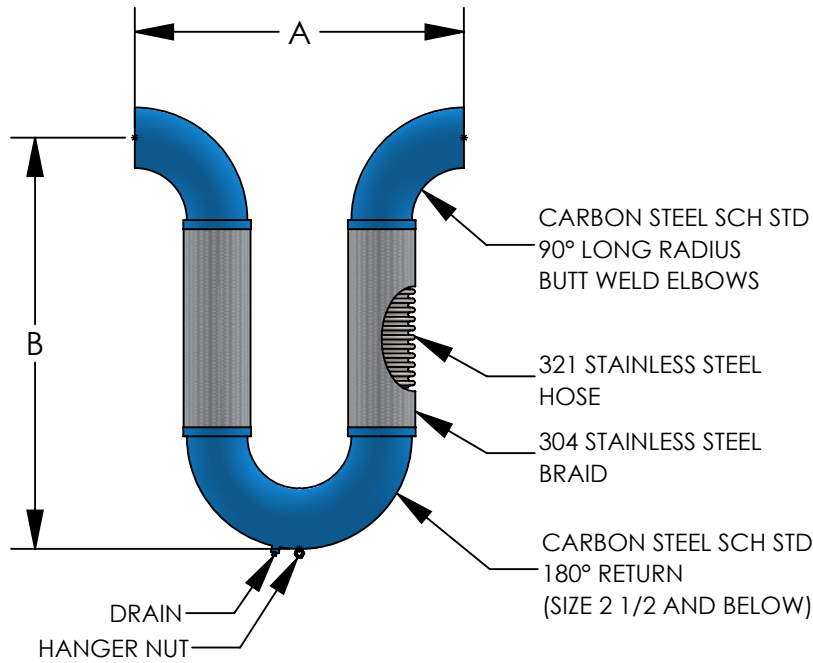

TEMP (°F)	FACTOR
70	1.00
150	0.97
200	0.94
300	0.88
400	0.83
500	0.78
600	0.77
1000	0.60
1400	0.42

NOTE: 5/8"-11 HANGER NUTS  
 INSTALLED ON ALL LOOPS  
 2 1/2" AND UP.  
 ALL LOOPS INCLUDE 3/8"  
 NPT DRAIN/AIR RELEASE PLUG

CONTACT FACTORY FOR ADDITIONAL SIZES AND MOVEMENTS. ALL UNITS IN INCHES UNLESS NOTED.

QTY.	PART NO.	SIZE	A	B	MVMT	SPRING RATE (LBS/IN)	PSI @ 70°F*		WT (LBS)
							SINGLE	DOUBLE	
	LOOPW80500	1/2	9	15 5/8	±4	12	1075	1720	5
	LOOPW80075	3/4	10	17 7/8	±4	12	792	1267	5
	LOOPW80100	1	10	18 5/8	±4	14	571	914	7
	LOOPW80125	1 1/4	10 3/4	20	±4	17	531	850	9
	LOOPW80150	1 1/2	11 1/2	21 1/4	±4	18	472	755	13
	LOOPW80200	2	14	24 1/2	±4	20	516	826	16
	LOOPW80250	2 1/2	15 1/2	28 1/4	±4	21	387	619	26
	LOOPW80300	3	18	30	±4	23	316	506	39
	LOOPW80400	4	24	35 3/8	±4	30	232	371	54
	LOOPW80500	5	30	40 1/4	±4	47	191	306	91
	LOOPW80600	6	36	45 3/8	±4	51	165	264	140
	LOOPW80800	8	48	53 1/2	±4	65	234	374	267
	LOOPW81000	10	60	63 1/4	±4	71	230	367	434
	LOOPW81200	12	72	72 3/4	±4	98	160	257	586

\*HOSE AND BRAID MAXIMUM WORKING PRESSURE RATING. FOR PRESSURE RATINGS AT OTHER TEMPERATURES,  
 CONSULT THE CORRECTION FACTOR TABLE ABOVE. LOOPS FOR STEAM APPLICATIONS WILL BE DOUBLE BRAIDED BUT USE  
 THE SINGLE BRAIDED PRESSURE RATING. LOOPS FOR STEAM APPLICATIONS SHOULD BE INSTALLED HORIZONTALLY TO PREVENT  
 CONDENSATE BUILD UP. CONTACT FACTORY FOR FURTHER INFORMATION.



2315 W. HUBBARD ST.  
 CHICAGO, IL 60612  
 TEL: 312-738-3588  
 FAX: 800-533-1024  
 WWW.FLEXICRAFT.COM

PROPOSAL/INQUIRY/ORDER NO:

CUSTOMER NAME:

PROJECT NAME:

CONTRACTOR:

## ML EXPANSION LOOP

WELD ENDS, ±4" MOVEMENT

DRAWN BY: JULIANH

DATE: 04/13/2026

APPROVED BY:

DATE:

DRAWING NO:

LOOPW8

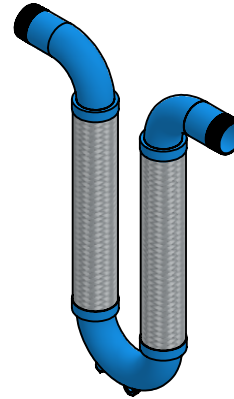
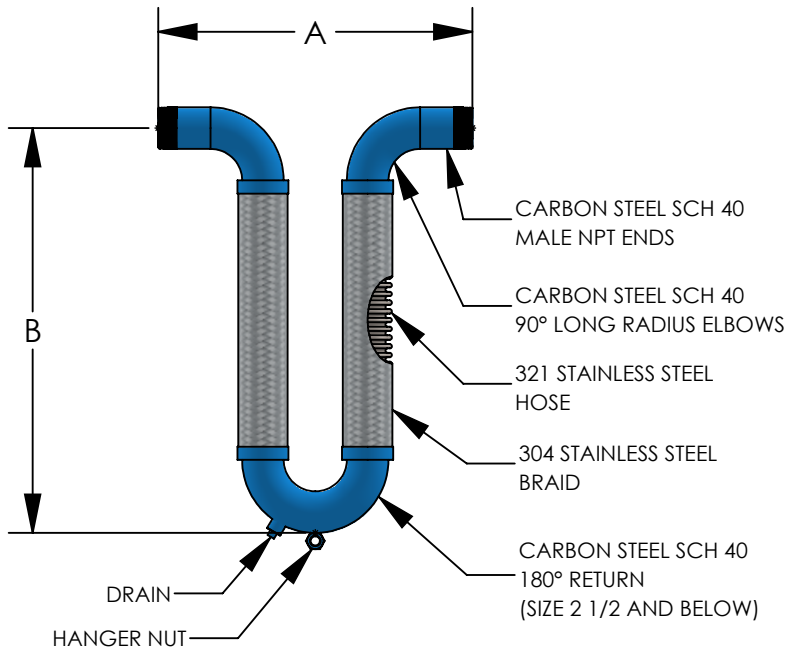

TEMP (°F)	FACTOR
70	1.00
150	0.97
200	0.94
300	0.88
400	0.83
500	0.78
600	0.77
1000	0.60
1400	0.42

NOTE: 5/8"-11 HANGER NUTS INSTALLED ON ALL LOOPS 2 1/2" AND UP.  
ALL LOOPS INCLUDE 3/8" NPT DRAIN/AIR RELEASE PLUG

CONTACT FACTORY FOR ADDITIONAL SIZES AND MOVEMENTS. ALL UNITS IN INCHES UNLESS NOTED.

QTY.	PART NO.	SIZE	A	B	MVMT	SPRING RATE (LBS/IN)	PSI @ 70°F*		WT (LBS)
							SINGLE	DOUBLE	
	LOOPT80500	1/2	15	15 5/8	±4	12	1075	1720	6
	LOOPT80075	3/4	16	17 7/8	±4	12	792	1267	6
	LOOPT80100	1	16	18 5/8	±4	14	571	914	8
	LOOPT80125	1 1/4	16 3/4	20	±4	17	531	850	10
	LOOPT80150	1 1/2	17 1/2	21 1/4	±4	18	472	755	15
	LOOPT80200	2	20	24 1/2	±4	20	516	826	18
	LOOPT80250	2 1/2	21 1/2	28 1/4	±4	21	387	619	29
	LOOPT80300	3	26	30	±4	23	316	506	43
	LOOPT80400	4	32	35 3/8	±4	30	232	371	59

\*HOSE AND BRAID MAXIMUM WORKING PRESSURE RATING. FOR PRESSURE RATINGS AT OTHER TEMPERATURES, CONSULT THE CORRECTION FACTOR TABLE ABOVE. MALE NPT FITTINGS ARE NOT RECOMMENDED FOR STEAM APPLICATIONS.



2315 W. HUBBARD ST.  
CHICAGO, IL 60612  
TEL: 312-738-3588  
FAX: 800-533-1024  
WWW.FLEXICRAFT.COM

PROPOSAL/INQUIRY/ORDER NO:

CUSTOMER NAME:

## ML EXPANSION LOOP

MALE NPT ENDS, ±4" MOVEMENT

PROJECT NAME:

DRAWN BY: JULIANH

DATE: 04/14/2026

APPROVED BY:

DATE:

CONTRACTOR:

DRAWING NO:

LOOPT8

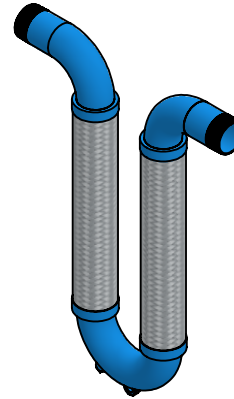
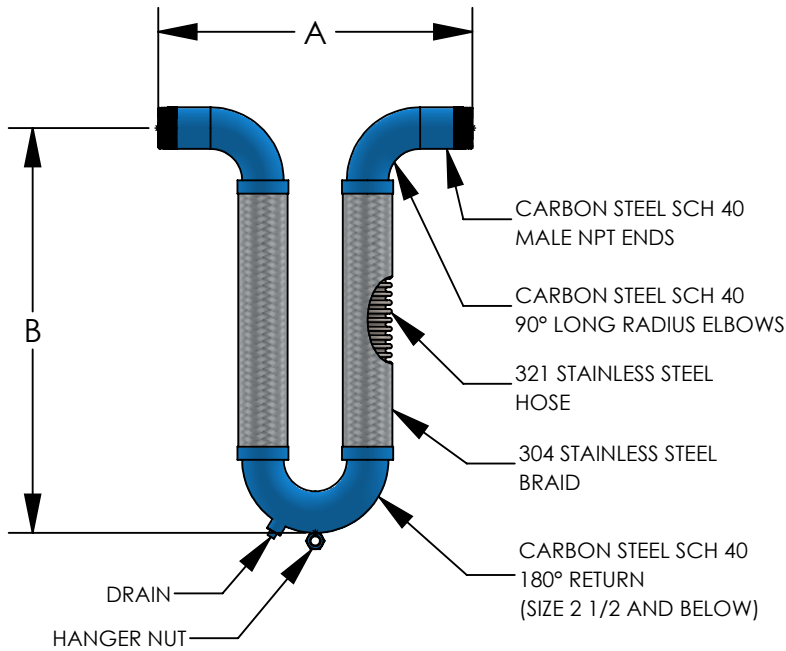

TEMP (°F)	FACTOR
70	1.00
150	0.97
200	0.94
300	0.88
400	0.83
500	0.78
600	0.77
1000	0.60
1400	0.42

NOTE: 5/8"-11 HANGER NUTS INSTALLED ON ALL LOOPS 2 1/2" AND UP.  
 ALL LOOPS INCLUDE 3/8" NPT DRAIN/AIR RELEASE PLUG

CONTACT FACTORY FOR ADDITIONAL SIZES AND MOVEMENTS. ALL UNITS IN INCHES UNLESS NOTED.

QTY.	PART NO.	SIZE	A	B	MVMT	SPRING RATE (LBS/IN)	PSI @ 70°F*		WT (LBS)
							SINGLE	DOUBLE	
	LOOPT30500	1/2	12	10 1/4	±1 1/2	30	1075	1720	3
	LOOPT30075	3/4	12	11 1/2	±1 1/2	32	792	1267	3
	LOOPT30100	1	12	12	±1 1/2	36	571	914	5
	LOOPT30125	1 1/4	13 1/2	13 3/8	±1 1/2	44	531	850	7
	LOOPT30150	1 1/2	15	14 3/4	±1 1/2	47	472	755	11
	LOOPT30200	2	18	17 3/8	±1 1/2	52	516	826	15
	LOOPT30250	2 1/2	21	21	±1 1/2	56	387	619	23
	LOOPT30300	3	26	23 3/8	±1 1/2	60	316	506	39
	LOOPT30400	4	32	28	±1 1/2	80	232	371	55

\*HOSE AND BRAID MAXIMUM WORKING PRESSURE RATING. FOR PRESSURE RATINGS AT OTHER TEMPERATURES, CONSULT THE CORRECTION FACTOR TABLE ABOVE. MALE NPT FITTINGS ARE NOT RECOMMENDED FOR STEAM APPLICATIONS.



2315 W. HUBBARD ST.  
 CHICAGO, IL 60612  
 TEL: 312-738-3588  
 FAX: 800-533-1024  
 WWW.FLEXICRAFT.COM

PROPOSAL/INQUIRY/ORDER NO:

CUSTOMER NAME:

PROJECT NAME:

CONTRACTOR:

## ML EXPANSION LOOP

MALE NPT ENDS, ±1 1/2" MOVEMENT

DRAWN BY: JULIANH

DATE: 04/14/2026

APPROVED BY:

DATE:

DRAWING NO:

LOOPT3

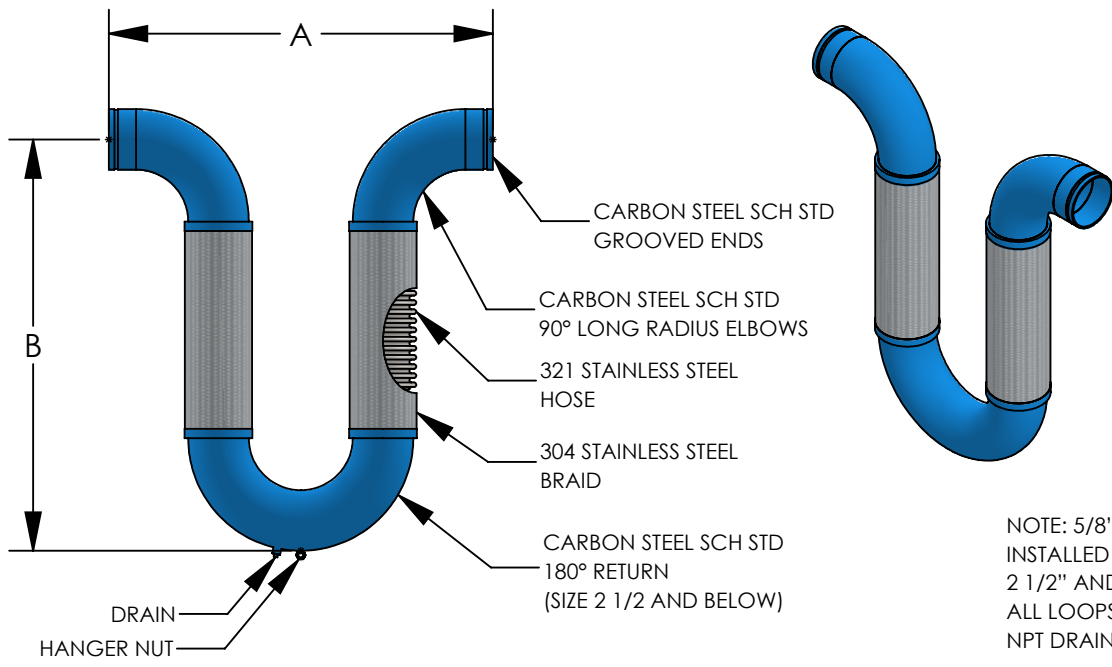

TEMP (°F)	FACTOR
70	1.00
150	0.97
200	0.94
300	0.88
400	0.83
500	0.78
600	0.77
1000	0.60
1400	0.42

NOTE: 5/8"-11 HANGER NUTS INSTALLED ON ALL LOOPS 2 1/2" AND UP.  
 ALL LOOPS INCLUDE 3/8" NPT DRAIN/AIR RELEASE PLUG

CONTACT FACTORY FOR ADDITIONAL SIZES AND MOVEMENTS. ALL UNITS IN INCHES UNLESS NOTED.

QTY.	PART NO.	SIZE	A	B	MVMT	SPRING RATE (LBS/IN)	PSI @ 70°F*		WT (LBS)
							SINGLE	DOUBLE	
	LOOPG80200	2	20	24 1/2	±4	20	516	826	18
	LOOPG80250	2 1/2	21 1/2	28 1/4	±4	21	387	619	29
	LOOPG80300	3	24	30	±4	23	316	506	43
	LOOPG80400	4	30	35 3/8	±4	30	232	371	60
	LOOPG80500	5	36	40 1/4	±4	47	191	306	99
	LOOPG80600	6	42	45 3/8	±4	51	165	264	150
	LOOPG80800	8	56	53 1/2	±4	65	234	374	286
	LOOPG81000	10	68	63 1/4	±4	71	230	367	461
	LOOPG31200	12	80	72 3/4	±4	98	160	257	622

\*HOSE AND BRAID MAXIMUM WORKING PRESSURE RATING. FOR PRESSURE RATINGS AT OTHER TEMPERATURES, CONSULT THE CORRECTION FACTOR TABLE ABOVE. GROOVED ENDS ARE NOT RECOMMENDED FOR STEAM APPLICATIONS.



2315 W. HUBBARD ST.  
 CHICAGO, IL 60612  
 TEL: 312-738-3588  
 FAX: 800-533-1024  
 WWW.FLEXICRAFT.COM

PROPOSAL/INQUIRY/ORDER NO:

CUSTOMER NAME:

PROJECT NAME:

CONTRACTOR:

**ML EXPANSION LOOP**  
 GROOVED ENDS, ±4" MOVEMENT

DRAWN BY: JULIANH DATE: 04/13/2026

APPROVED BY: DATE:

DRAWING NO: LOOPG8

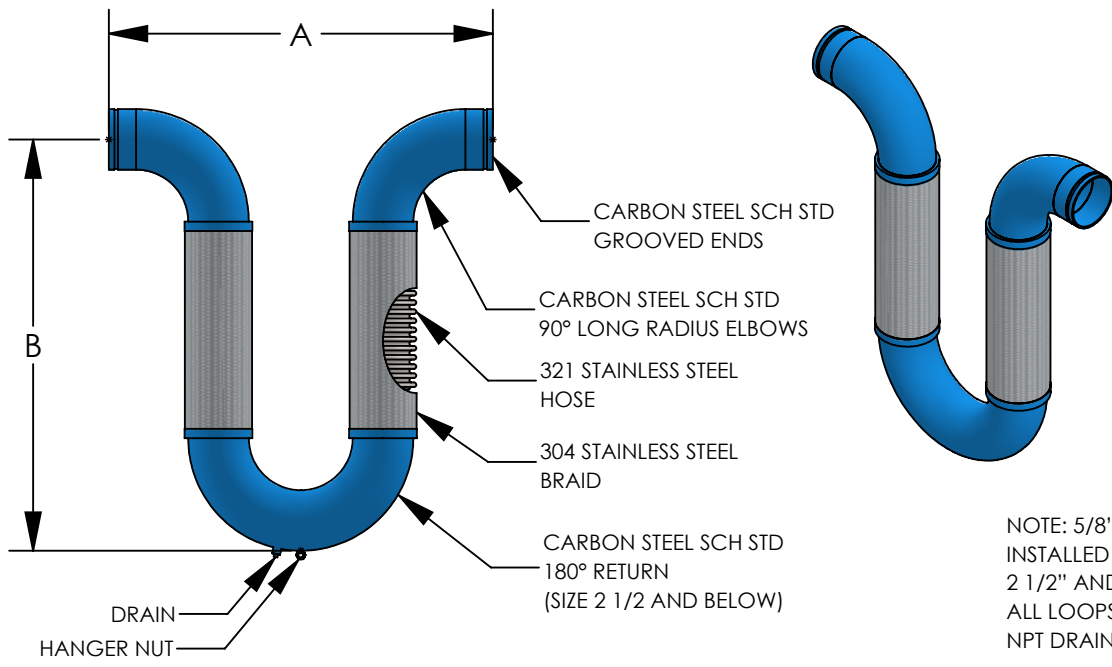

TEMP (°F)	FACTOR
70	1.00
150	0.97
200	0.94
300	0.88
400	0.83
500	0.78
600	0.77
1000	0.60
1400	0.42

NOTE: 5/8"-11 HANGER NUTS INSTALLED ON ALL LOOPS 2 1/2" AND UP. ALL LOOPS INCLUDE 3/8" NPT DRAIN/AIR RELEASE PLUG

CONTACT FACTORY FOR ADDITIONAL SIZES AND MOVEMENTS. ALL UNITS IN INCHES UNLESS NOTED.

QTY.	PART NO.	SIZE	A	B	MVMT	SPRING RATE (LBS/IN)	PSI @ 70°F*		WT (LBS)
							SINGLE	DOUBLE	
	LOOPG30200	2	18	17 3/8	±1 1/2	52	516	826	15
	LOOPG30250	2 1/2	21	21	±1 1/2	56	387	619	23
	LOOPG30300	3	24	23 3/8	±1 1/2	60	316	506	39
	LOOPG30400	4	30	28	±1 1/2	80	232	371	54
	LOOPG30500	5	36	32 1/4	±1 1/2	124	191	306	89
	LOOPG30600	6	42	36 3/4	±1 1/2	135	165	264	135
	LOOPG30800	8	56	44 1/2	±1 1/2	174	234	374	264
	LOOPG31000	10	68	53 1/4	±1 1/2	189	230	367	430
	LOOPG31200	12	80	61 3/4	±1 1/2	260	160	257	592

\*HOSE AND BRAID MAXIMUM WORKING PRESSURE RATING. FOR PRESSURE RATINGS AT OTHER TEMPERATURES, CONSULT THE CORRECTION FACTOR TABLE ABOVE. GROOVED ENDS ARE NOT RECOMMENDED FOR STEAM APPLICATIONS.

	2315 W. HUBBARD ST. CHICAGO, IL 60612 TEL: 312-738-3588 FAX: 800-533-1024 WWW.FLEXICRAFT.COM	PROPOSAL/INQUIRY/ORDER NO:
	CUSTOMER NAME:	
<b>ML EXPANSION LOOP</b> GROOVED ENDS, ±1 1/2" MOVEMENT		PROJECT NAME:
DRAWN BY: JULIANH	DATE: 04/13/2026	CONTRACTOR:
APPROVED BY:	DATE:	
DRAWING NO: LOOPG3		