

MODEL EP EXPANSION JOINT 150PSI FLANGE END

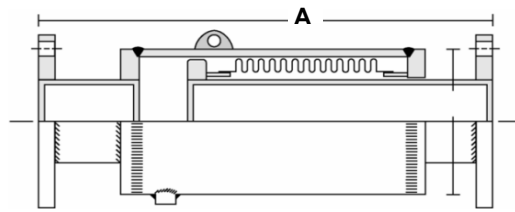

FLANGED ENDS



The externally pressurized EP solves the problem of long axial travel for expansion joints. It comes standard for movements of 4", 6" and 8". They are available in 150 and 300 psi models, and can be configured as doubles if required.

Maximum Working Pressure 150 psi
 Working Temperature 850°F
 Test Pressure 225 psi
 Bellows 2-Ply T304 S/S
 Ends 150# Flanges

Dim		Movements			Physicals		Weight	Product No.	Dim		Movements			Physicals		Weight	Product No.
Pipe Size	Type	Length A	Ax Comp	Ax Ext	Thrust Area	Stiffness			Pipe Size	Type	Length A	Ax Comp	Ax Ext	Thrust Area	Stiffness		
in	S/M/L	in	in	in	in ²	lbs/in	lbs	in	S/M/L	in	in	in	in ²	lbs/in	lbs		
2	S	25	4	0.75	13	183	34	EP1504SF0200	10	S	27	4	0.75	125	400	240	EP1504SF1000
2	M	31.5	6	1	13	115	41	EP1506SF0200	10	M	34	6	1	125	280	281	EP1506SF1000
2	L	38.5	8	1.5	13	92	50	EP1508SF0200	10	L	40.25	8	1.5	125	200	342	EP1508SF1000
2.5	S	25	4	0.75	13	183	40	EP1504SF0250	12	S	27	4	0.75	167	463	308	EP1504SF1200
2.5	M	32	6	1	13	115	48	EP1506SF0250	12	M	33.25	6	1	167	326	355	EP1506SF1200
2.5	L	38.5	8	1.5	13	92	58	EP1508SF0250	12	L	39.75	8	1.5	167	235	428	EP1508SF1200
3	S	24	4	0.75	21	343	51	EP1504SF0300	14	S	28.25	4	0.75	212	1328	491	EP1504SF1400
3	M	30	6	1	21	235	60	EP1506SF0300	14	M	36	6	1	212	885	565	EP1506SF1400
3	L	38.5	8	1.5	21	172	75	EP1508SF0300	14	L	45.5	8	1.5	212	1053	671	EP1508SF1400
4	S	25	4	0.75	36	200	61	EP1504SF0400	16	S	28.75	4	0.75	276	1425	547	EP1504SF1600
4	M	31.25	6	1	36	143	89	EP1506SF0400	16	M	36.25	6	1	276	950	631	EP1506SF1600
4	L	37.75	8	1.5	36	103	110	EP1508SF0400	16	L	46	8	1.5	276	712	749	EP1508SF1600
5	S	25	4	0.75	47	235	112	EP1504SF0500	18	S	29	4	0.75	338	1596	652	EP1504SF1800
5	M	31.5	6	1	47	166	133	EP1506SF0500	18	M	36.5	6	1	338	1064	745	EP1506SF1800
5	L	38.25	8	1.5	47	120	165	EP1508SF0500	18	L	46.25	8	1.5	338	798	875	EP1508SF1800
6	S	25.5	4	0.75	59	269	138	EP1504SF0600	20	S	29.75	4	0.75	404	1766	766	EP1504SF2000
6	M	32.25	6	1	59	189	162	EP1506SF0600	20	M	37.25	6	1	404	1177	868	EP1506SF2000
6	L	38.5	8	1.5	59	138	200	EP1508SF0600	20	L	47	8	1.5	404	883	1012	EP1508SF2000
8	S	28.25	4	0.75	89	332	198	EP1504SF0800	24	S	30.25	4	0.75	481	1936	961	EP1504SF2400
8	M	34.75	6	1	89	235	230	EP1506SF0800	24	M	38	6	1	481	1290	1081	EP1506SF2400
8	L	42	8	1.5	89	166	283	EP1508SF0800	24	L	47.5	8	1.5	481	968	1250	EP1508SF2400

	Proposal/Inquiry/Order No.:	NOTES:
	Customer Name:	
Project Name:		
Contractor:		
Model EP expansion joints combine excellent performance and economy. They can usually be provided quickly.		

MODEL EP EXPANSION JOINT 150PSI WELD END

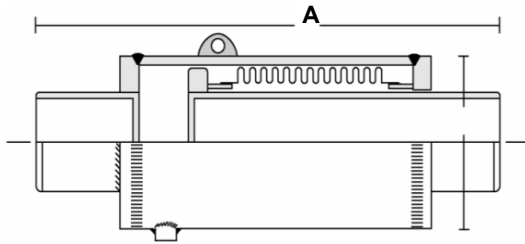

WELD ENDS

The externally pressurized EP solves the problem of long axial travel for expansion joints. It comes standard for movements of 4", 6" and 8". They are available in 150 and 300 psi models, and can be configured as doubles if required.

Maximum Working Pressure 150 psi
 Working Temperature 850°F
 Test Pressure 225 psi
 Bellows 2-Ply T304 S/S
 Ends Weld Ends

Dim		Movements		Physicals		Weight	Product No.	Dim		Movements		Physicals		Weight	Product No.		
Pipe Size	Type	Length A	Ax Comp	Ax Ext	Thrust Area			Stiffness	Pipe Size	Type	Length A	Ax Comp	Ax Ext			Thrust Area	Stiffness
in	S/M/L	in	in	in	in ²	lbs/in	lbs	in	S/M/L	in	in	in	in ²	lbs/in	lbs		
2	S	24.25	4	0.75	13	183	26	EP1504SW0200	10	S	26	4	0.75	125	400	186	EP1504SW1000
2	M	31	6	1	13	115	33	EP1506SW0200	10	M	33	6	1	125	280	227	EP1506SW1000
2	L	37.75	8	1.5	13	92	42	EP1508SW0200	10	L	39.25	8	1.5	125	200	238	EP1508SW1000
2.5	S	24.5	4	0.75	13	183	29	EP1504SW0250	12	S	26	4	0.75	167	463	226	EP1504SW1200
2.5	M	31.25	6	1	13	115	37	EP1506SW0250	12	M	32.25	6	1	167	326	273	EP1506SW1200
2.5	L	38	8	1.5	13	92	47	EP1508SW0250	12	L	38.75	8	1.5	167	235	346	EP1508SW1200
3	S	23.25	4	0.75	21	343	38	EP1504SW0300	14	S	24.5	4	0.75	212	1328	293	EP1504SW1400
3	M	29.5	6	1	21	235	47	EP1506SW0300	14	M	32	6	1	212	885	367	EP1506SW1400
3	L	37.75	8	1.5	21	172	62	EP1508SW0300	14	L	41.75	8	1.5	212	1053	473	EP1508SW1400
4	S	24.25	4	0.75	36	200	59	EP1504SW0400	16	S	24.5	4	0.75	276	1425	329	EP1504SW1600
4	M	30.75	6	1	36	143	73	EP1506SW0400	16	M	32	6	1	276	950	412	EP1506SW1600
4	L	37.25	8	1.5	36	103	94	EP1508SW0400	16	L	41.75	8	1.5	276	712	530	EP1508SW1600
5	S	24.25	4	0.75	47	235	91	EP1504SW0500	18	S	24.5	4	0.75	338	1596	364	EP1504SW1800
5	M	30.75	6	1	47	166	112	EP1506SW0500	18	M	32	6	1	338	1064	456	EP1506SW1800
5	L	37.5	8	1.5	47	120	144	EP1508SW0500	18	L	41.75	8	1.5	338	798	588	EP1508SW1800
6	S	24.75	4	0.75	59	269	115	EP1504SW0600	20	S	24.5	4	0.75	404	1766	400	EP1504SW2000
6	M	31.5	6	1	59	189	139	EP1506SW0600	20	M	32	6	1	404	1177	501	EP1506SW2000
6	L	37.75	8	1.5	59	138	177	EP1508SW0600	20	L	41.75	8	1.5	404	883	646	EP1508SW2000
8	S	27.25	4	0.75	89	332	153	EP1504SW0800	24	S	24.5	4	0.75	481	1936	472	EP1504SW2400
8	M	33.75	6	1	89	235	185	EP1506SW0800	24	M	32	6	1	481	1290	590	EP1506SW2400
8	L	41	8	1.5	89	166	238	EP1508SW0800	24	L	41.75	8	1.5	481	968	761	EP1508SW2400

	Proposal/Inquiry/Order No.:	NOTES:
	Customer Name:	
Project Name:		
Contractor:		
Model EP expansion joints combine excellent performance and economy. They can usually be provided quickly.		
PRINT CERTIFICATION: Certified Correct As Of: _____ By: _____		

MODEL EP EXPANSION JOINT 300PSI FLANGE END

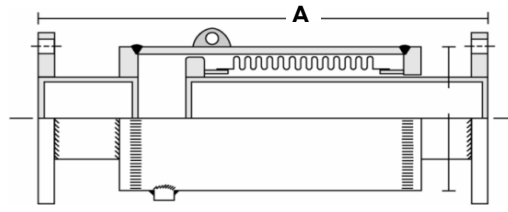

FLANGED

The externally pressurized EP solves the problem of long axial travel for expansion joints. It comes standard for movements of 4", 6" and 8". They are available in 150 and 300 psi models, and can be configured as doubles if required.

Maximum Working Pressure 300 psi
 Working Temperature 850°F
 Test Pressure 450 psi
 Bellows 2-Ply T304 S/S
 Ends 300# Flanges

Dim		Movements			Physicals		Weight	Product No.	Dim		Movements			Physicals		Weight	Product No.
Pipe Size	Type	Length A	Ax Comp	Ax Ext	Thrust Area	Stiffness			Pipe Size	Type	Length A	Ax Comp	Ax Ext	Thrust Area	Stiffness		
in	L/M/S	in	in	in	in ²	lbs/in	lbs	in	L/M/S	in	in	in	in ²	lbs/in	lbs		
2	S	25.75	4	0.75	12	388	49	EP3004SF0200	10	S	28.5	4	0.75	135	3266	396	EP3004SF1000
2	M	34.75	6	1	12	260	63	EP3006SF0200	10	M	35.75	6	1	135	2177	452	EP3006SF1000
2	L	41.75	8	1.5	12	194	72	EP3008SF0200	10	L	44.75	8	1.5	135	1633	534	EP3008SF1000
2.5	S	25.75	4	0.75	12	388	56	EP3004SF0250	12	S	30.5	4	0.75	182	3491	540	EP3004SF1200
2.5	M	34.75	6	1	12	260	73	EP3006SF0250	12	M	38.25	6	1	182	2327	610	EP3006SF1200
2.5	L	41.75	8	1.5	12	194	84	EP3008SF0250	12	L	47.75	8	1.5	182	1745	712	EP3008SF1200
3	S	24.5	4	0.75	16	504	75	EP3004SF0300	14	S	30.75	4	0.75	212	2656	732	EP3004SF1400
3	M	31	6	1	16	380	87	EP3006SF0300	14	M	38.5	6	1	212	1770	828	EP3006SF1400
3	L	39.5	8	1.5	16	252	106	EP3008SF0300	14	L	48	8	1.5	212	1328	966	EP3008SF1400
4	S	25.75	4	0.75	30	850	121	EP3004SF0400	16	S	31.5	4	0.75	276	2850	798	EP3004SF1600
4	M	32.5	6	1	30	566	141	EP3006SF0400	16	M	39.25	6	1	276	1900	905	EP3006SF1600
4	L	41.25	8	1.5	30	424	170	EP3008SF0400	16	L	48.75	8	1.5	276	1424	1060	EP3008SF1600
5	S	24.5	4	0.75	42	1002	158	EP3004SF0500	18	S	31.75	4	0.75	338	3192	1007	EP3004SF1800
5	M	30.75	6	1	42	668	181	EP3006SF0500	18	M	39.5	6	1	338	2128	1126	EP3006SF1800
5	L	36.75	8	1.5	42	501	203	EP3008SF0500	18	L	49	8	1.5	338	1596	1297	EP3008SF1800
6	S	25.25	4	0.75	53	1140	190	EP3004SF0600	20	S	32	4	0.75	404	3532	1189	EP3004SF2000
6	M	31.25	6	1	53	760	214	EP3006SF0600	20	M	39.75	6	1	404	2354	1319	EP3006SF2000
6	L	37.5	8	1.5	53	570	239	EP3008SF0600	20	L	49.25	8	1.5	404	1766	1507	EP3008SF2000
8	S	26.75	4	0.75	83	2424	295	EP3004SF0800	24	S	33	4	0.75	481	3872	1619	EP3004SF2400
8	M	33.5	6	1	83	1616	336	EP3006SF0800	24	M	40.75	6	1	481	2580	1772	EP3006SF2400
8	L	40	8	1.5	83	1212	377	EP3008SF0800	24	L	50.25	8	1.5	481	1936	1993	EP3008SF2400

	Proposal/Inquiry/Order No.:	NOTES:
	Customer Name:	
	Project Name:	
	Contractor:	
PRINT CERTIFICATION: Certified Correct As Of: _____ By: _____	Model EP expansion joints combine excellent performance and economy. They can usually be provided quickly.	

MODEL EP EXPANSION JOINT 300PSI WELD END

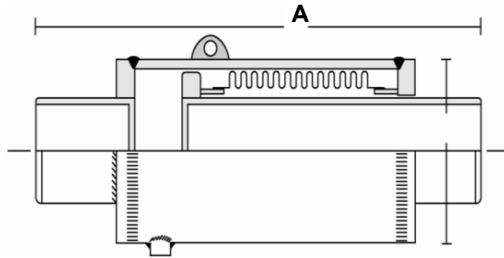

WELD

The externally pressurized EP solves the problem of long axial travel for expansion joints. It comes standard for movements of 4", 6" and 8". They are available in 150 and 300 psi models, and can be configured as doubles if

Maximum Working Pressure 300 psi
 Working Temperature 850°F
 Test Pressure 450 psi
 Bellows 2-Ply T304 S/S
 Ends Weld Ends

Dim			Movements		Physicals		Weight	Product No.
Pipe Size	Type	Length A	Ax Comp	Ax Ext	Thrust Area	Stiffness		
in	S/M/L	in	in	in	in ²	lbs/in	lbs	
2	S	23.25	4	0.75	12	388	35	EP3004SW0200
2	M	32	6	1	12	260	48	EP3006SW0200
2	L	39.25	8	1.5	12	194	58	EP3008SW0200
2.5	S	23.25	4	0.75	12	388	36	EP3004SW0250
2.5	M	32	6	1	12	260	52	EP3006SW0250
2.5	L	39.25	8	1.5	12	194	63	EP3008SW0250
3	S	22.25	4	0.75	16	504	47	EP3004SW0300
3	M	28.5	6	1	16	380	59	EP3006SW0300
3	L	37.25	8	1.5	16	252	78	EP3008SW0300
4	S	22.75	4	0.75	30	850	74	EP3004SW0400
4	M	29.5	6	1	30	566	94	EP3006SW0400
4	L	38.5	8	1.5	30	424	124	EP3008SW0400
5	S	21.5	4	0.75	42	1002	97	EP3004SW0500
5	M	27.5	6	1	42	668	120	EP3006SW0500
5	L	33.75	8	1.5	42	501	143	EP3008SW0500
6	S	21.5	4	0.75	53	1140	106	EP3004SW0600
6	M	27.5	6	1	53	760	130	EP3006SW0600
6	L	33.75	8	1.5	53	570	155	EP3008SW0600
8	S	22.5	4	0.75	83	2424	168	EP3004SW0800
8	M	29	6	1	83	1616	209	EP3006SW0800
8	L	35.75	8	1.5	83	1212	250	EP3008SW0800
10	S	23.75	4	0.75	135	3266	216	EP3004SW1000
10	M	30.75	6	1	135	2177	272	EP3006SW1000
10	L	40	8	1.5	135	1633	354	EP3008SW1000
12	S	25	4	0.75	182	3491	285	EP3004SW1200
12	M	32.5	6	1	182	2327	355	EP3006SW1200
12	L	42.25	8	1.5	182	1745	457	EP3008SW1200
14	S	25	4	0.75	212	2656	373	EP3004SW1400
14	M	32.5	6	1	212	1770	468	EP3006SW1400
14	L	42.25	8	1.5	212	1328	607	EP3008SW1400
16	S	25	4	0.75	276	2850	418	EP3004SW1600
16	M	32.5	6	1	276	1900	525	EP3006SW1600
16	L	42.25	8	1.5	276	1424	680	EP3008SW1600
18	S	25	4	0.75	338	3192	463	EP3004SW1800
18	M	32.5	6	1	338	2128	581	EP3006SW1800
18	L	42.25	8	1.5	338	1596	753	EP3008SW1800
20	S	25	4	0.75	404	3532	508	EP3004SW2000
20	M	32.5	6	1	404	2354	637	EP3006SW2000
20	L	42.25	8	1.5	404	1766	826	EP3008SW2000
24	S	25	4	0.75	481	3872	598	EP3004SW2400
24	M	32.5	6	1	481	2580	750	EP3006SW2400
24	L	42.25	8	1.5	481	1936	972	EP3008SW2400

	Proposal/Inquiry/Order No.:	NOTES:
	Customer Name:	
Project Name:		
Contractor:		
Model EP expansion joints combine excellent performance and economy. They can usually be provided quickly.		
PRINT CERTIFICATION: Certified Correct As Of: _____ By: _____		